



Repico®

1. Repico® types

Repico® G Repico® S Repico® SG



Grip

Slip

Slip-Grip

2. Installatie voorwaarden

2.1 Controleer label

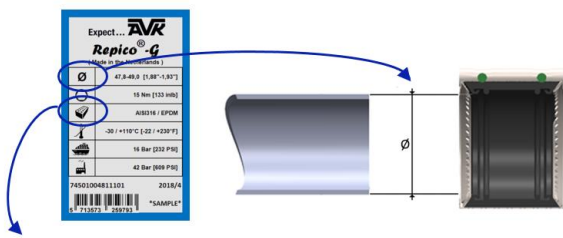

Controleer maximale druk!

| Rubber | |
|----------|------------------|
| EPDM | -30 °C ↔ +110 °C |
| NBR | -25 °C ↔ + 80 °C |
| Silicone | -70 °C ↔ +200 °C |
| Viton | -30 °C ↔ +250 °C |

2.2 Maximale afstand

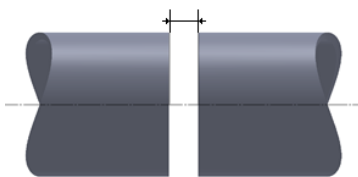

| C_{max} | |
|-------------|----------|
| DN15 ↔ DN65 | 0 ↔ 8mm |
| >DN80 | 0 ↔ 15mm |

2.3 Hoekverdraaiing

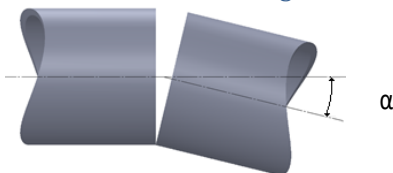

| α_{max} | |
|----------------|----|
| DN15 ↔ DN50 | 5° |
| DN65 ↔ DN175 | 4° |
| >DN200 | 2° |

2.4 Diameter

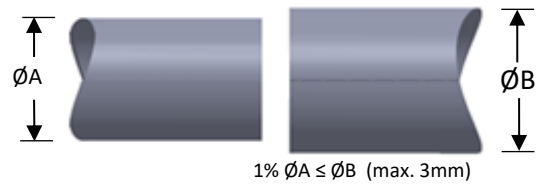

$$1\% \varnothing A \leq \varnothing B \text{ (max. 3mm)}$$

2.5 Misuitlijning

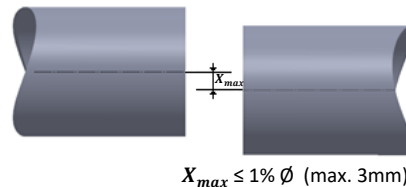

$$X_{max} \leq 1\% \varnothing \text{ (max. 3mm)}$$

2.6 Ovaliteit

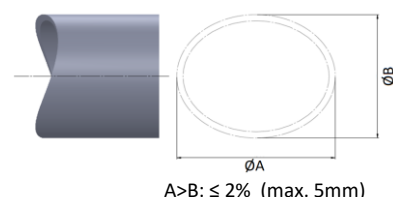

$$A > B: \leq 2\% \text{ (max. 5mm)}$$

3. Voorbereidingen

3.1 Bouten losdraaien



3.2 Pijp markeren

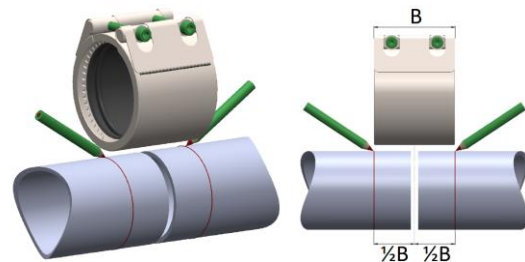

3.3 Pijp schoonmaken

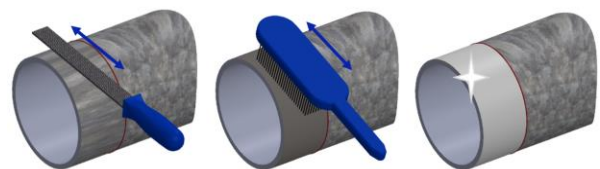

3.4 Steunbus - PE pijp

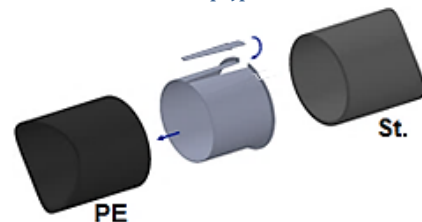



4. Montage

4.1 Schuiven

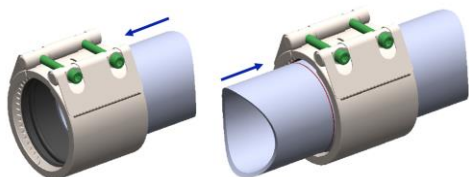

4.2 Gedeeltelijk aandraaien

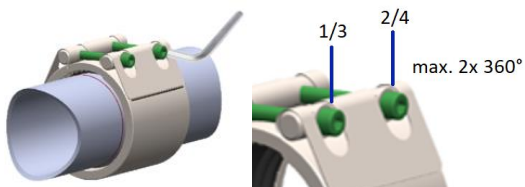

4.3 Geen rotatie

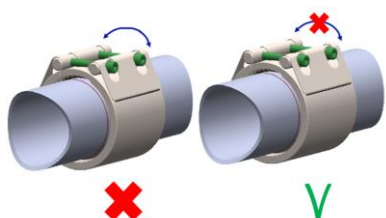

4.4 Aanhaalmoment

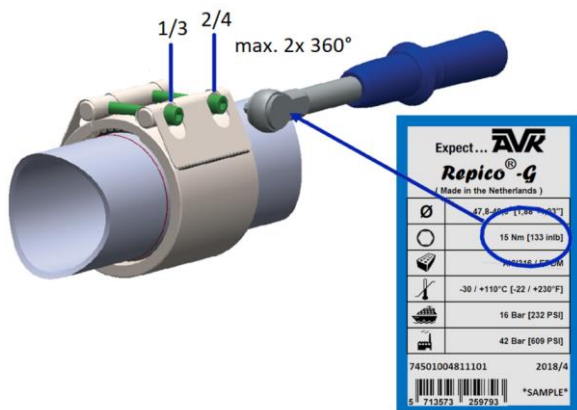

4.5 Lekkage controle (zicht en reuk)

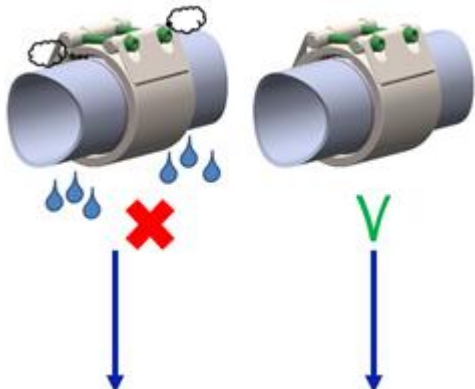

Done ✓

| | |
|----|----------------|
| 5. | Demontage |
| 3. | Vorbereidingen |
| 4. | Montage |

5. Demontage

5.1 Druk eraf

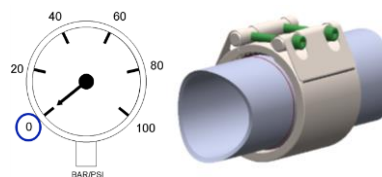

5.2 Voorzichtig! - lekkage



5.3 Pijp ondersteunen

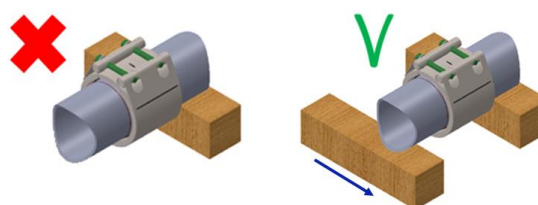

5.4 Bouten losdraaien



5.5 Schuiven! Niet roteren

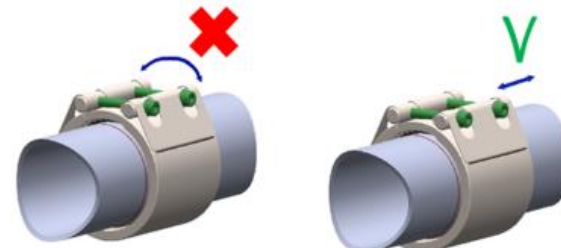

5.6 Verwijderen

