



Repico®

1. Repico® types

Repico® G Repico® S Repico® SG



Grip

Slip

Slip-Grip

2. Installation conditions

2.1 Check label

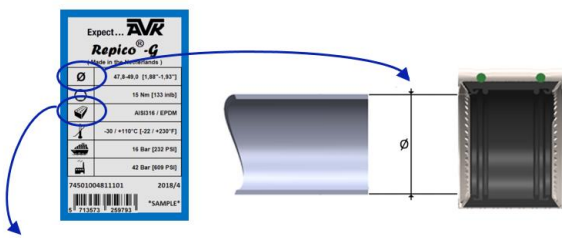

Check pressure rate!

Gasket	
EPDM	-30 °C ↔ +110 °C
NBR	-25 °C ↔ + 80 °C
Silicone	-70 °C ↔ +200 °C
Viton	-30 °C ↔ +250 °C

2.2 Maximum gap

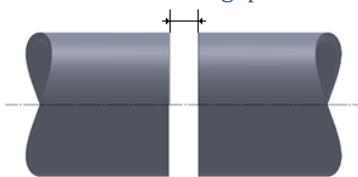

C_{max}	
DN15 ↔ DN65	0 ↔ 8mm
>DN80	0 ↔ 15mm

2.3 Angular deflection

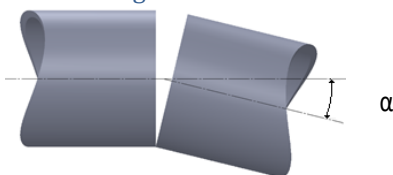

α_{max}	
DN15 ↔ DN50	5°
DN65 ↔ DN175	4°
>DN200	2°

2.4 Diameter

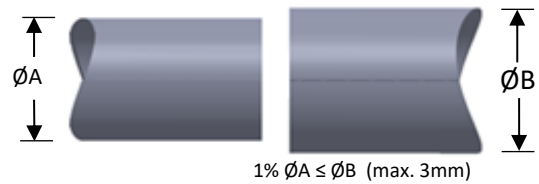

$$1\% \phi A \leq \phi B \text{ (max. 3mm)}$$

2.5 Misalignment

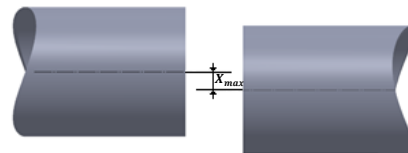

$$X_{max} \leq 1\% \phi \text{ (max. 3mm)}$$

2.6 Ovality

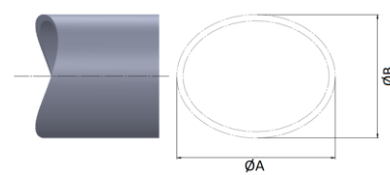

$$A > B: \leq 2\% \text{ (max. 5mm)}$$

3. Preparations

3.1 Loosen bolts

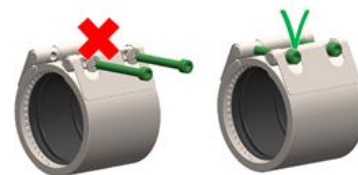

3.2 Mark pipe

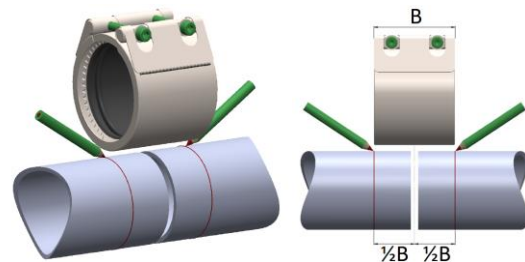

3.3 Clean pipe

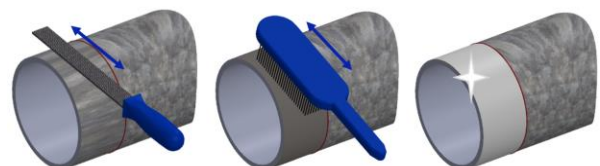

3.4 Insert - PE pipe

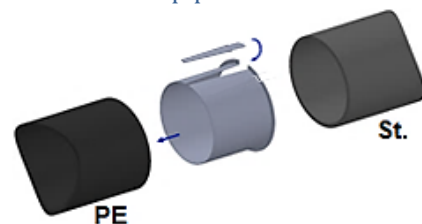



AVK REPICO® Coupling

Mounting instructions

Series 745

4. Assembly

4.1 Slide

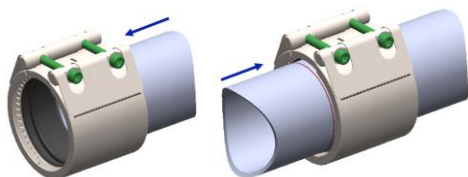

4.2 Tighten partial

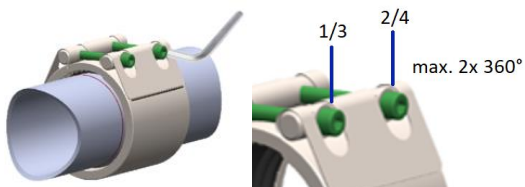

4.3 No rotating

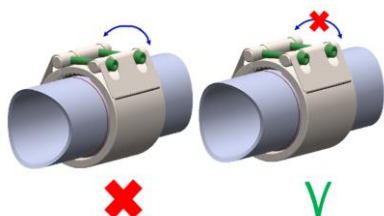

4.4 Apply torque

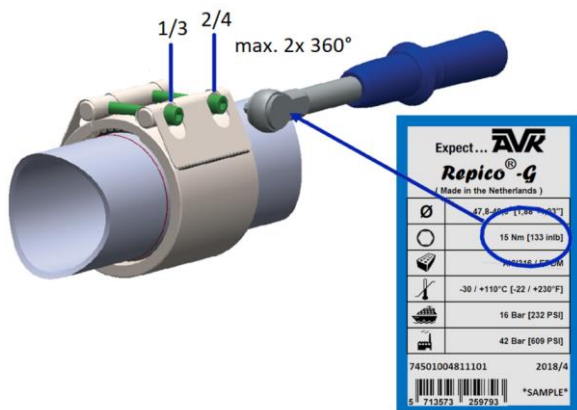

4.5 Leakage control (look and smell)

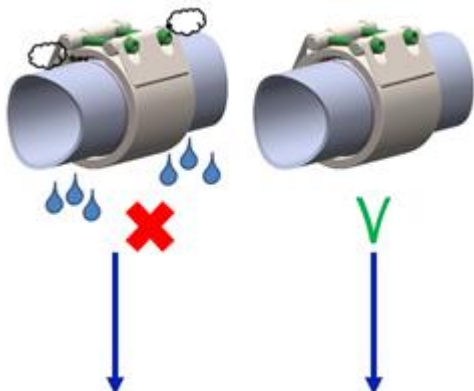

5. Dissassembly
3. Preparations
4. Assembly

Done ✓

5. Disassembly

5.1 Unpressurized

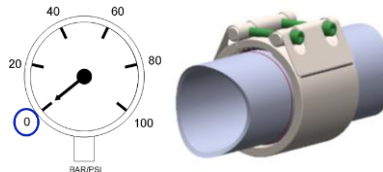

5.2 Careful - leakage



5.3 Support pipe

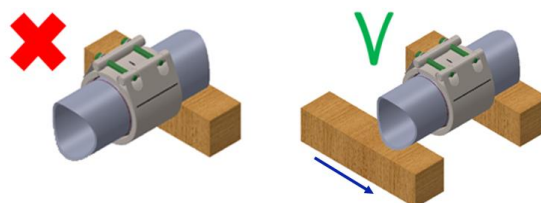

5.4 Loosen bolts



5.5 Slide, no rotating

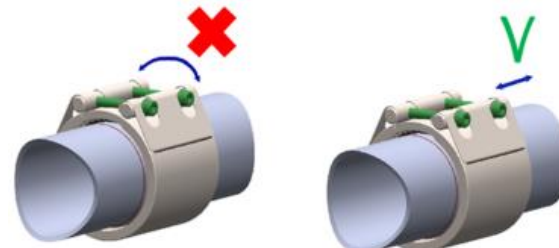

5.6 Removal

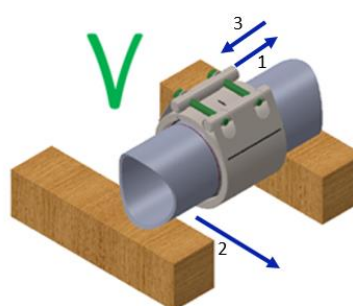

Expect... **AVR**